

## Accessing the Library Catalogue with Windows 7

If you can't get beyond the library catalogue login screen, use the file attached to the email you received these instructions with.

Look for the attachment called **NTLMSetting1.txt**

Save this file to your computer; any folder is fine.

You **must** rename the file as:

### NTLMSetting1.reg

To save the file, right click it and then select the **save** option, i.e. **Save link as...**

Select a location to save it – it won't matter where as long as it is the computer you want to use to access the library catalogue and you can find the file again.

**Rename** the file to **NTLMSetting1.reg**

Click **Save**.

Locate the file on your computer and right click it:

Select **Open with...**

Select **Registry Editor** from the options and click **OK**:

Click **Run**.

**A series of pop up boxes will appear:**

Click **Yes** to allow the program to run on your computer, then select **Yes** for the next box and **OK** on the final box.

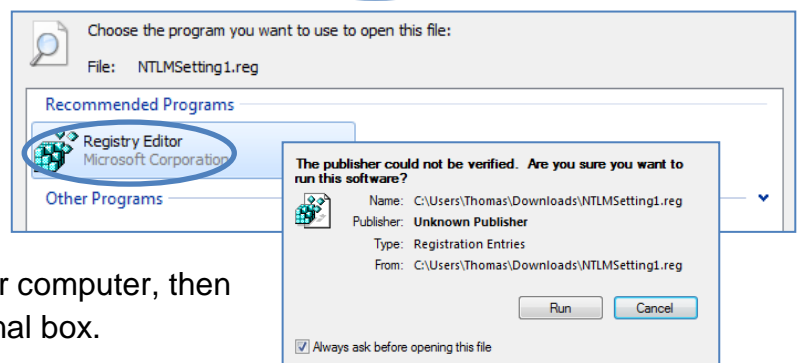
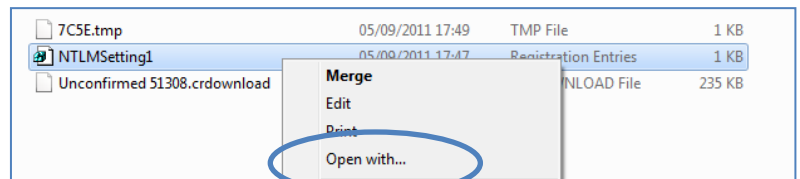
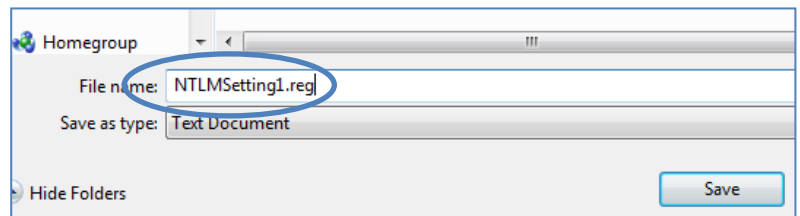
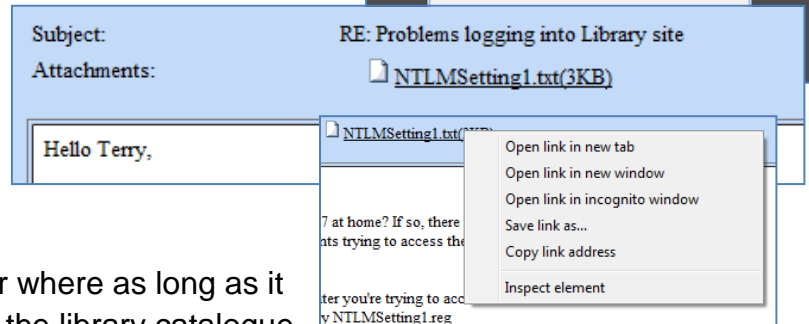
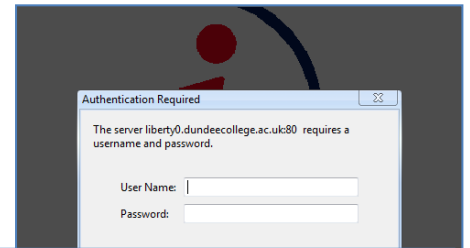

When you return to the library catalogue and login again you should now get access, even without refreshing the page or opening it in a new window:

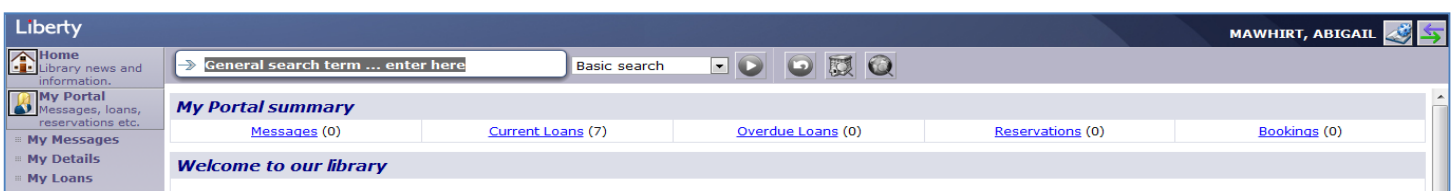

If you have any problems accessing the library catalogue or other resources, please contact the Learning Hub staff: [learninghub@dundeecollege.ac.uk](mailto:learninghub@dundeecollege.ac.uk) or 01382 834813 / 834849